

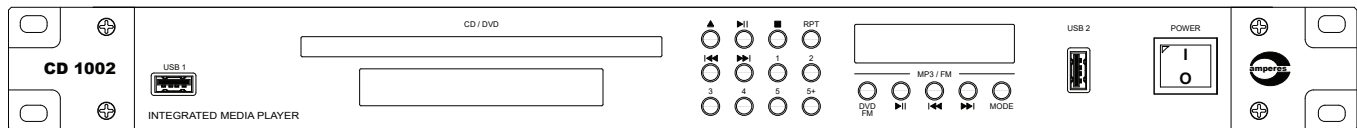

INSTRUCTION MANUAL

CD1002

Integrated Dual Channel
CD / DVD / USB / BT / FM Player



Thank you for choosing another quality product from Amperes Electronics

Product in Summary

Amperes CD1002 is a compact integrated media player with dual outputs., which means the unit is able to stream dual audio output simultaneously. It comprises of two USB inputs, DVD / CD audio player, Bluetooth and FM tuner.

It is suitable for professional PA installations with rack space savings with its 1 hu height.

Please read through the manual to capture how CD1002 may serve your needs diligently and efficiently. We are confident that you are getting a product of excellence.



Scan to view catalogue and latest updates
Ver 2 / 1024

In our support towards environment, we shall no longer print manuals to be accompanied with each product. Please view through browser and print them only when necessary.



Parts Identification

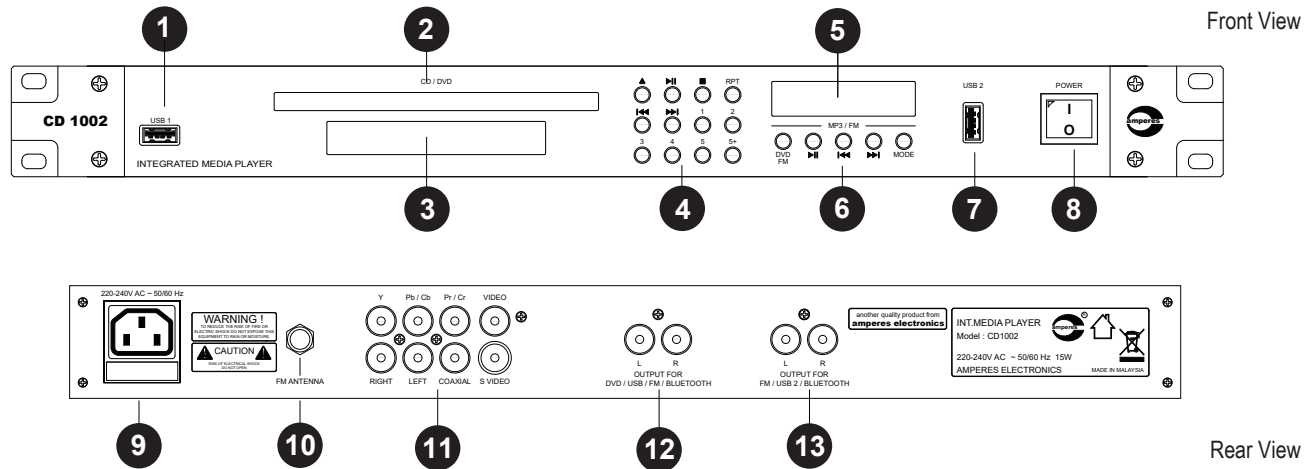

1. USB INPUT 1

USB port 1 for audio out channel 1 (Output at part no.12)

2. CD COMPARTMENT

Front loading CD compartment, accepts CD and DVD disc formats.

3. CD AND USB 1 FUNCTIONS DISPLAY

LCD display for CD player functions

4. FUNCTION KEYS FOR USB 1 AND CD/DVD

Buttons to control USB and CD/DVD players such as ejects, pause, play, fast forward and reverse and file jogs.

5. LCD DISPLAY FOR FM / BT / USB 2

LCD Display for FM tuner, Bluetooth and USB 2 audio sources

6. FUNCTION KEY FOR FM / BT / USB 2

Buttons to control media selection for DVD, FM, Bluetooth and USB 2

7. USB INPUT 2

USB port 2 for audio output channel 2 (Output at part no.13.)

8. POWER SWITCH

AC power switch for the unit

9. FUSED AC INLET

Fused AC inlet for 200 - 240V AC ; 50 / 60 Hz power source.

10. FM ANTENNA CONNECTOR

Plug in dipole cable antenna provided to this jack

11. AUDIO / VIDEO OUTPUT FOR DVD

Outputs for DVD player with audio, composite video and components.

12. RCA CHANNEL 1 OUTPUT

Stereo outputs for DVD and USB 1,2 , FM and Bluetooth

13. RCA CHANNEL 2 OUTPUT

Stereo outputs for USB 2, FM and Bluetooth.

Remote Controller

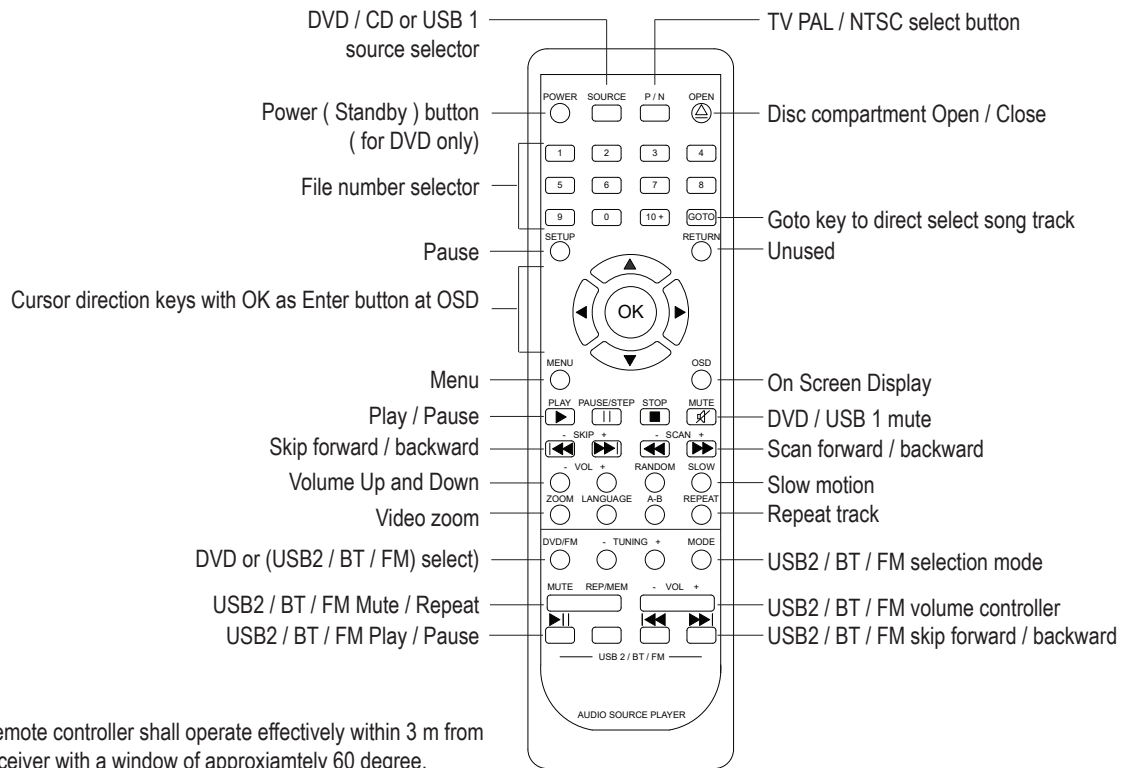

The remote controller shall operate effectively within 3 m from the receiver with a window of approximately 60 degree.

General Schematic Diagram

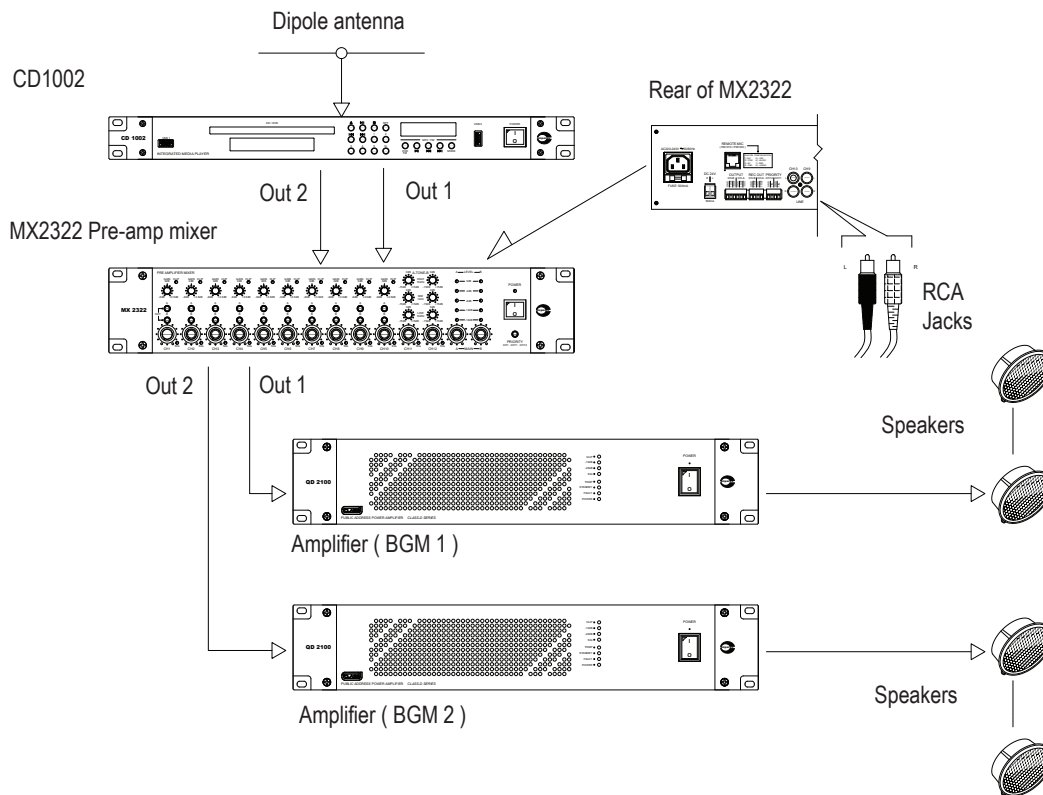

The above schematic shows CD1002 is used to provide 2 sources of BGM to mixer. However, the user shall have the option to :

- Play single source with either one of the player being selected (with only output A connected)
- Play dual source with both outputs connected (A and B - Refer diagram at page 4)

Operating the Unit (Output A)

There are 2 outputs from CD1002, which has independent source selection and controls.

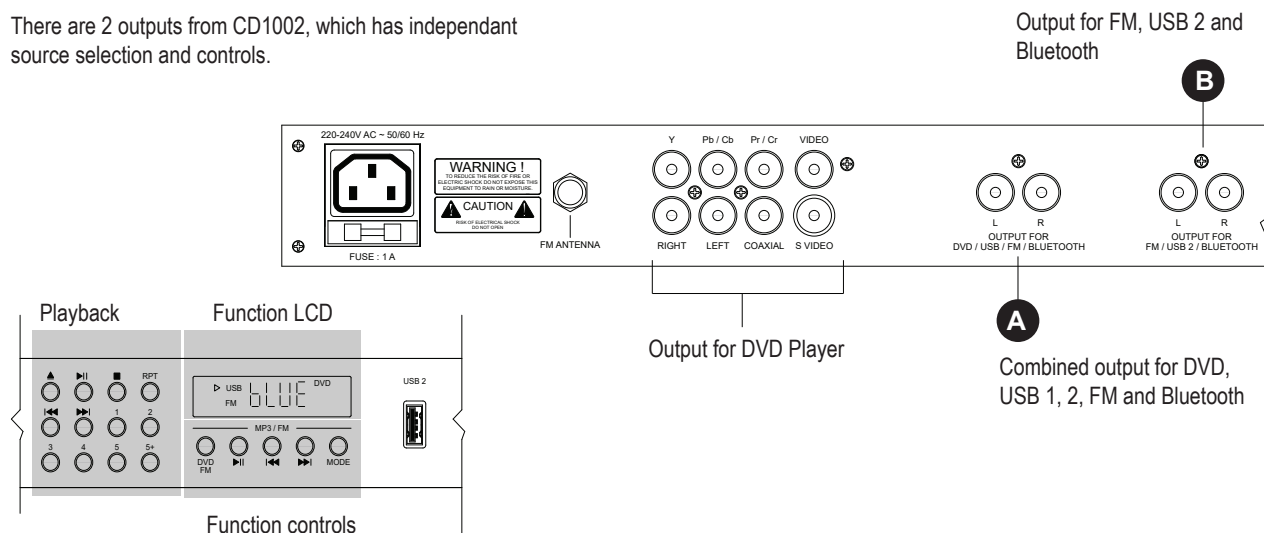

TO PLAY CD / DVD :

- Press "DVD/FM" button and DVD indicator shall be shown on the display
- Open CD compartment by pressing "Open / Close" button (▲)
- Press "Play" button to play CD (▶||)

CD playback can be skipped, fast forward, pause, stop or go to desired file number directly from the front panel Playback Control buttons or using remote controller.

Information on CD playback is shown at CD Functions Display.

TO PLAY FM RADIO :

- Press "DVD/FM" button and FM indicator shall be shown on the display
- Use Forward (▶||) or Backward (||◀) buttons to shift pre-programmed radio station which is indicated by "P01"

To save the radio channels, please refer to the section " Saving Radio Channels "

TO PLAY USB 1 FILES :

- Plug USB drive to USB1 slot. If CD is inside the tray, press Stop (■) momentarily and USB mode will begin, or use remote controller, select " Source "
- Press "DVD/FM" button with "USB" indicator shown in the TFT panel
- To play the USB song, press "Play/Pause" button and other controls at Playback Control keys

TO PLAY USB 2 FILES

- Plug USB drive to USB2 slot. It will auto detect and both ▶ and **DVD** symbols displayed.
- Press "DVD/FM" button with ▶ indicator on only. It will play the files in the USB drive automatically.
- Use the buttons at Function Controls to manipulate songs

You can toggle between DVD and USB2 for output 1 by pressing DVD/FM button.

TO PLAY BLUETOOTH FILES FROM MOBILE DEVICE

- Press "Mode" button to choose Bluetooth function, and at this mode the "bt" word will appear and ▶ symbol shall blink if not connected to any device.
- Open your mobile device to search for bluetooth connection name "Amperes".
- Select and pair your device with CD1002, the symbol ▶ shall stop blinking
- CD1002 is then ready to receive audio from your mobile devices.

TO CONTROL OUTPUT VOLUME

Output volume can be adjusted at the function controls button as well as from remote controller. In FM mode, the volume can only be adjusted by using the remote controller.

Operating the Unit (Output B)

Output B provides audio from either of the followings :

- FM
- USB 2
- Bluetooth

To operate audio output B, the steps are similar with Output A. Only USB 2 is connected for the channel.

Follow the steps as per page 5 to select the desired audio source.

Although Channel A and B can provide audio output simultaneously, do take note that :

- Output A and B can share the same source at the same time (Except CD)
- While Output A is playing DVD, Output B can only play either USB2, FM or Bluetooth

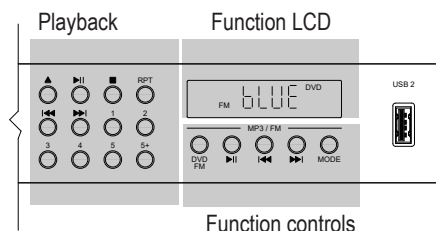

DVD Component Outputs

The 3rd output from CD1002 is the Stereo audio with video outputs together with its video component signals. These outputs provides continuous playback regardless of selection at function controls.

To control DVD or CD playback, use the 'Playback' controls or use remote controller provided.

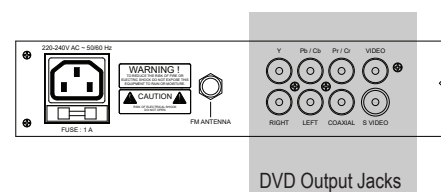

Radio Station Presets

99 radio station presets can be stored in the device. It can be saved in auto mode or done manually. Each preset will be displayed as "P01", "P 02" ..

1. AUTO SEARCH & SAVING

- Press "MODE" button to select FM reception mode
- Press Play (▶||) and hold momentarily, the search will start automatically.
- At each detected good frequency, it will be stored as "P01" until all frequencies are searched.

2. MANUAL SEARCH AND SAVE

This mode allows you to search the desired station and save it to your preferred preset number. For tuning of frequency, we suggest that the remote controller to be used for faster setting.

- Press (▶▶) momentarily for 3 seconds
- Adjust the frequency desired using remote controller and press (▶||) promptly. The station will be automatically save to the next available preset slot.

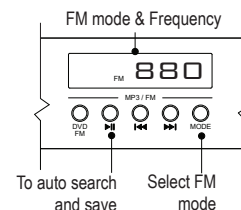
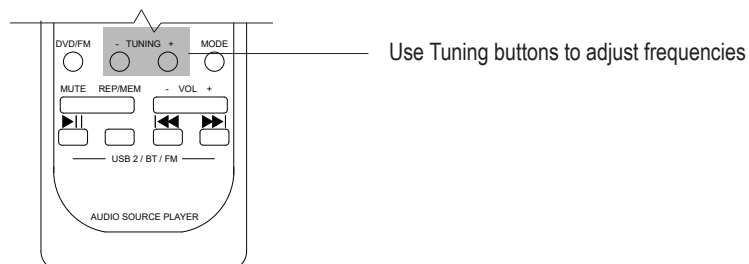

2. DELETE A PRESET

A saved preset can be deleted, and the next preset will take the position of the deleted number. Example. Preset 03 will occupy deleted Preset 02 and will renamed itself as P02. To delete a preset,

- Select the Preset number to delete by using Forward / Backward keys.
- Press Mode button for 3 seconds to delete.

Summary of Features

- Compact 1 hu rack mounted integrated media player with dual USB, CD/DVD, Bluetooth and FM Tuner
- Dual output with simultaneous playback at both output channels
- Supports various formats : CD / DVD, MP3
- With remote controls
- With DVD composite video and component outputs
- Dipole FM antenna for better radio reception
- 99 preset memory for FM radio
- Suitable for retails, boutiques, gymns and other centralised PA installations

Technical Specifications

Operating voltage	220 - 240V AC
Power consumption	15W (240V AC)
Channels	2
Playback media	CD / DVD / FM / USB, Bluetooth
USB playback format	MP3
USB memory supported	32 GB
FM radio reception	87.5 - 108 MHz (50kHz step)
FM memory presets	99
Output	RCA Stereo line out (0 dBV, 0.775V)
Frequency response (CD)	20 - 20 kHz
S/N ratio	> 80 dB
Distortion	< 0.5% : 1 kHz
Working temperature	0 - 45 deg C
Humidity	85 %
Dimensions (WxHxD) mm	482 x 44 x 365
Net weight (kg)	2.70

Warranty Conditions

Only Amperes Electronics Service Centres are allowed to make warranty repairs : a list of Amperes Electronics authorized service centres may be asked by the purchaser or send directly to Amperes Electronics Sdn Bhd at 70 Jalan Industri PBP3, Tmn Perindustrian Pusat Bandar Puchong, 47100, Puchong, Selangor. This warranty is not valid if repairs are performed by unauthorized personnel or service centres.

Eligibility

Amperes Electronics' Service Center will accept any device send in for repair / checking purchased from any of our dealers. Some dealers may have the right to refuse repair / service / checking for any device not purchased from them directly.

Coverage

This warranty covers only repairs and replacement of defective parts, due to defects of components or workmanship during product warranty period. For any product purchased exceeding the warranty period, a cost of repair shall be presented and will only proceed to rectifications upon agreed value. If the owner decides not to proceed, a minimal checking fees will be applied.

Exclusions

This warranty does not cover damages caused by misuse, negligence in application as well as using the product with power supply voltage other than shown on the product, or any other power supply source / adapter not recommended by the manufacturer.

This warranty does not cover damages caused by fire, earthquakes, floods, lightning and every cause not directly related to the unit.

This warranty certificate is valid only for the described product, and is not valid if modifications are made on this certificate or identification labels applied to the unit or any other modifications to the physical unit other than its intended usage.

Duration / Warranty Period

This warranty covers all the material and manufacturing defects and is valid for a period of 36 months from the date of purchase or for a specified period in countries where this is stated by a national law. In this case, the extension is valid only in the country where the product is purchased.

Cost of Claiming Warranty

Cost and risk of transportation as well as removal and installation of the product from the main system are for the account of the purchaser. This warranty shall not extend to the replacement of the unit.

Limitations

This warranty does not include any indemnity in favor of the purchaser or the dealer for the period out of use of the unit, moreover the warranty does not cover any damages which may cause to the people and things during the use of the product. Our liability is limited to the cost of the product

Amperes Electronics Sdn Bhd is not obliged to modify previously manufactured products under warranty if the design changes or improvements are made.

The purchaser is deemed to agree to the above warranty conditions once the product packaging is unpacked., Otherwise the product shall be returned to the seller in proper original condition.

Disclaimer

Information contained in this manual is subjected to change without prior notice and does not represent a commitment on the part of the vendor. Amperes Electronics Sdn Bhd shall not be liable for any loss or damages whatsoever arising from the use of information or any error contained in this manual.

It is recommended that all services and repairs of this product to be carried out by Amperes Electronics or its authorized service agents.

Amperes products must only be used for the purpose they were intended by the manufacturer and in conjunction with this operation manual.

Amperes Electronics Sdn Bhd cannot accept any liability whatsoever for any loss or damages caused by service, maintenance or repair by unauthorized personnel, or by use other than that intended by the manufacturer.



Registered to certificate: 16895/ A/ 0001/ UK/ En



AMPERES ELECTRONICS SDN BHD
MADE IN MALAYSIA
Published : OCT 2024