

POWER DISTRIBUTIONS

BC9740 24V DC Automatic Battery Charger

BC9740 is the next generation of innovative Battery Charger, which has been engineered to meet the requirement of installers and users alike. It is compact in 1 HU height, built with the latest technology for efficient charging, controls and monitoring purpose. Driven by powerful ARM processor, it works to protect against connection error, prolonging battery life with its battery monitoring feature and communicates to provide human interaction. RS485 data port is available for external monitoring via PMX II Software and can be readily linked up to LAN through iPX5500 Com Box.



Features

- Constant DC voltage charging for 24V battery bank
- 4A initial charging current with reducing rate over charging time
- Built in surge protection
- Output short circuit protection
- Thermal protection against overheating
- Auto low battery disconnection with LCD indication
- Battery reversed polarity protection
- Rear mains switch to avoid unnecessarily switching off the unit
- RS485 communication for remote monitoring via PMX LAN software

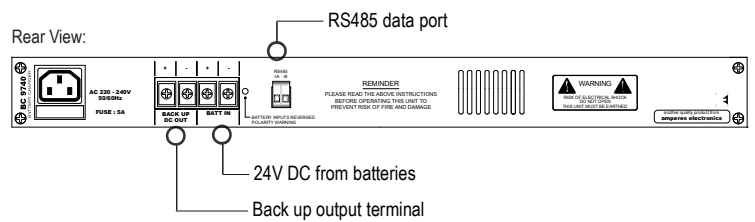

Technical Specifications

Operating voltage	220 - 240V AC
Charging voltage	27.8V DC
Charging current	4A; (max 5A)
Idle power consumption	1.3W
Protections	Low battery auto disconnection, reverse polarity, short circuit
Indications	AC mains, short circuit and low battery
Displays	Charging current Charging voltage Battery voltage Output current Battery reverse polarity
Communication	RS485 out; link to Amperes PMX LAN via iPX5500 comm. box for remote monitoring
E/M back up Amp rating	25A max (Use external contactor / relay if required)
Terminals	Battery input , EM load
Dimensions (W x H x D)	482 x 44 x 180 mm
Weight	4.50 kg

Application Schematics

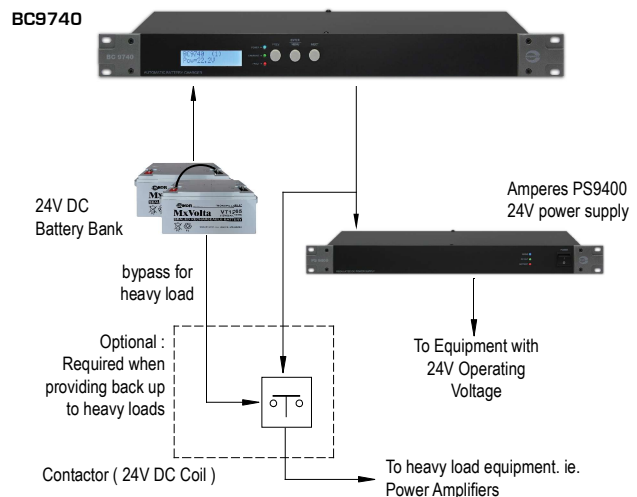

Packing information

Carton size : 555 (L) x 295 (W) x 95 (H) mm
Gross weight : 5.20 kg
1 unit per carton

